

Reva and David Logan Center for the Arts
University of Chicago

Schematic Lighting Design Presentation

Sean Kim
November 11, 2013

Overview

Building Type: Multidisciplinary arts center

Size: 184,000 square foot

Stories: 11-story tower with
3-story adjacent building

Owner: University of Chicago

Design Architect: Tod Williams Billie Tsien Architects

Lighting Design: Refro Design Group

MEP Engineer: Ambrosino Depinto & Schmieder
Consulting Engineering

Construction Manager: Turner Construction, LLC



Location

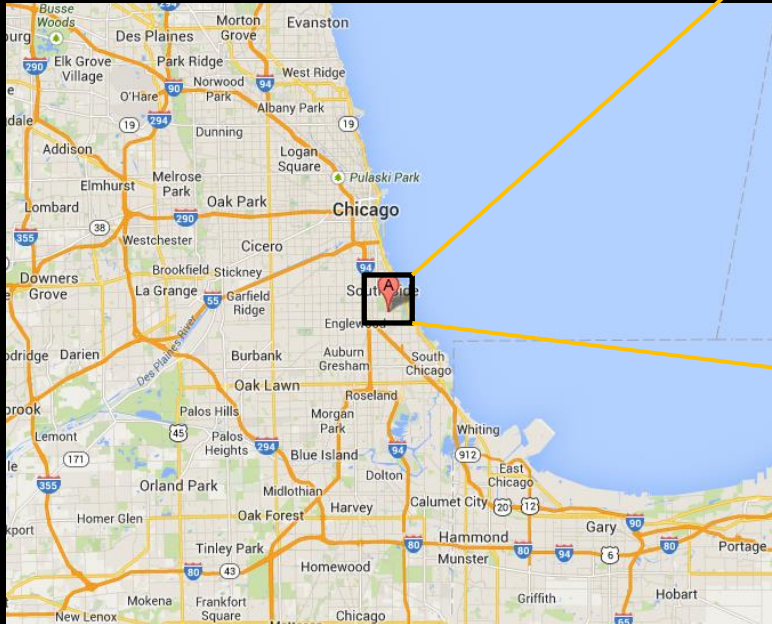

Location: 915 E 60th St, Chicago IL, 60637

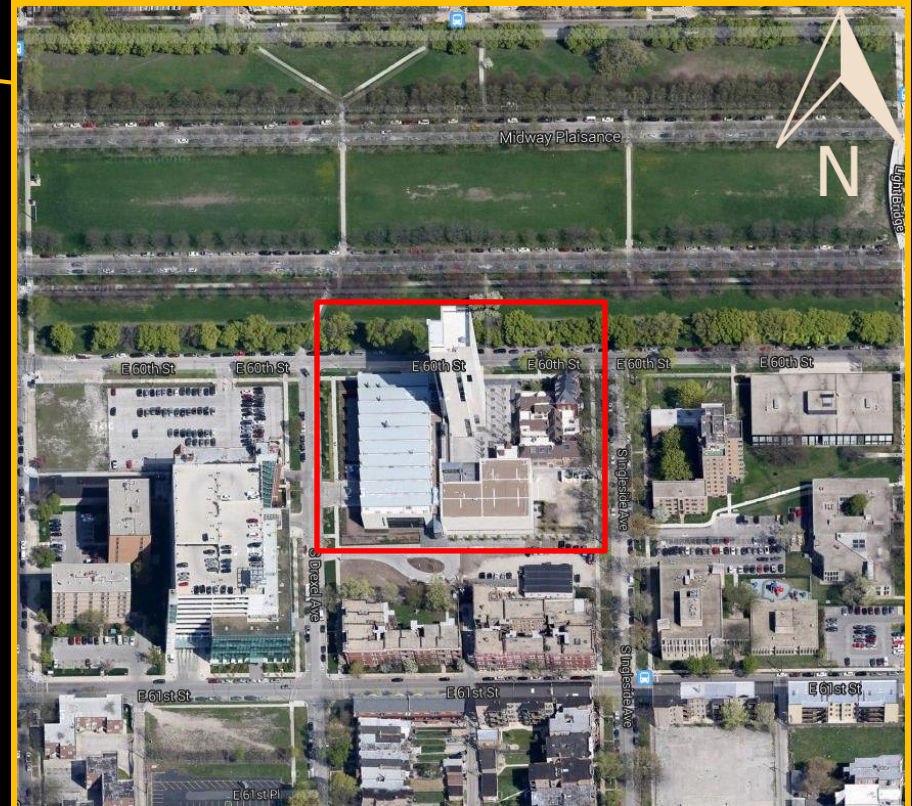

Design and Mission

*“The David and Reva Logan Center for the Arts will add luster to the university’s already rich history of groundbreaking **artistic** exploration and accomplishment, and become a model of its kind on the national stage.”*

- Larry Norman, Deputy Provost for the Arts

*“The idea of the low, sky lit building of studios and theaters, and the tower of the arts came from imagining the **flat prairies of the Midwest** and the great towers of Chicago.”*

- Tod Williams, Architects

The Reva and David Logan Center for the Arts advances arts practice, inquiry, and presentation at the University of Chicago, and fosters meaningful collaboration and **cultural** engagement at the university, on the south side, and in the city of Chicago.

- From the mission of Logan Family

The Reva and David Logan Center for the Arts is fully operational as a **vibrant** home for the study, practice, and presentation of arts at the UChicago.

- From the Design of Logan Center for the Arts

Inspiration in UChicago

artistic



[wodumedia.com]

flat prairies of the Midwest



[loganlaunch.uchicago.edu]

cultural



[arts.uchicago.edu]

vibrant



[www.theallertonhotel.com]

Space overview

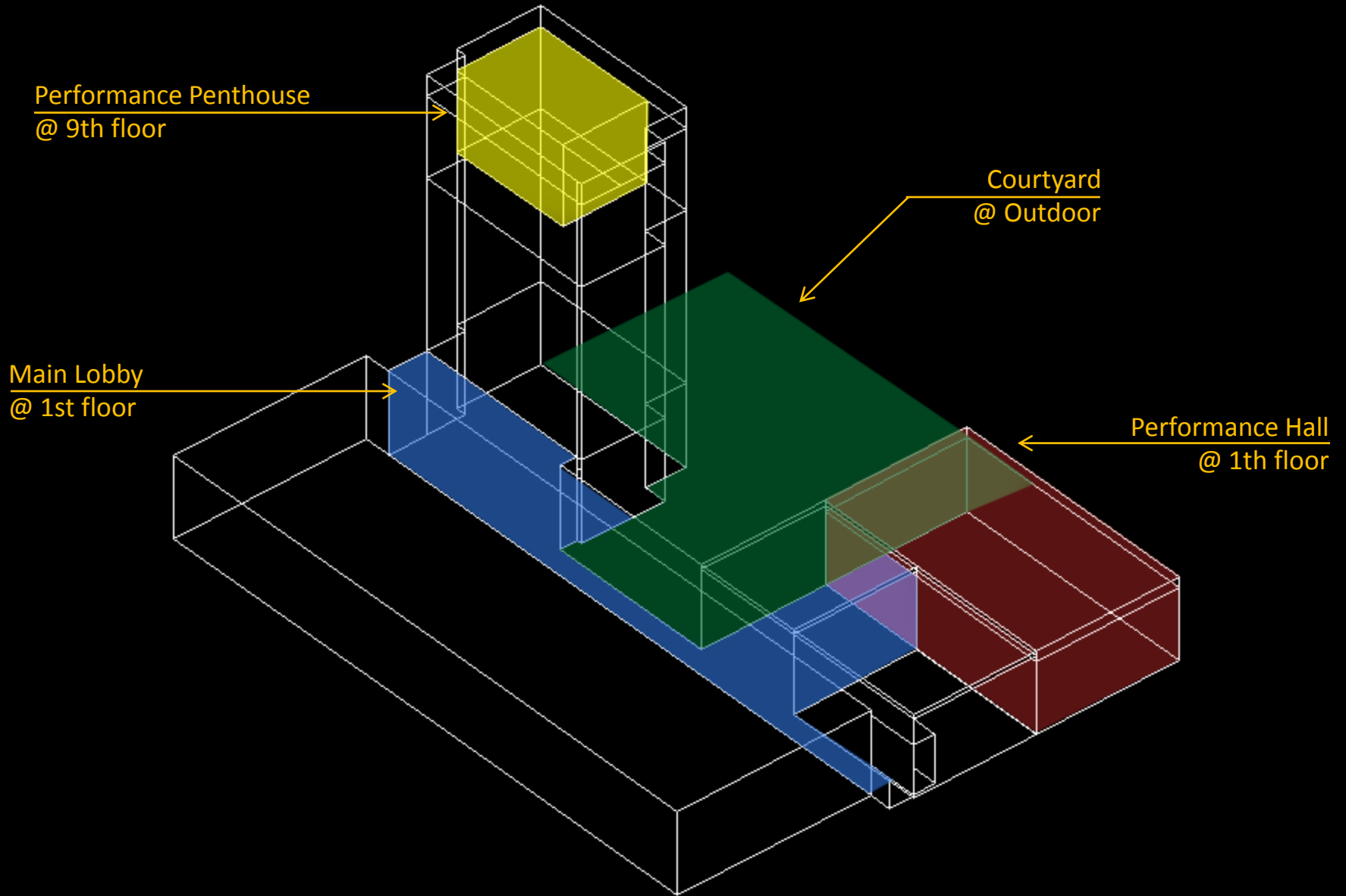

Main Lobby



Space purpose

- Primary Entrance
- Circulation
- Gallery
- Exhibition

Design goal

- Create welcoming environment
- Powerful atmosphere
- Flexible lighting system
- Collaborate public with private scene

Main Lobby

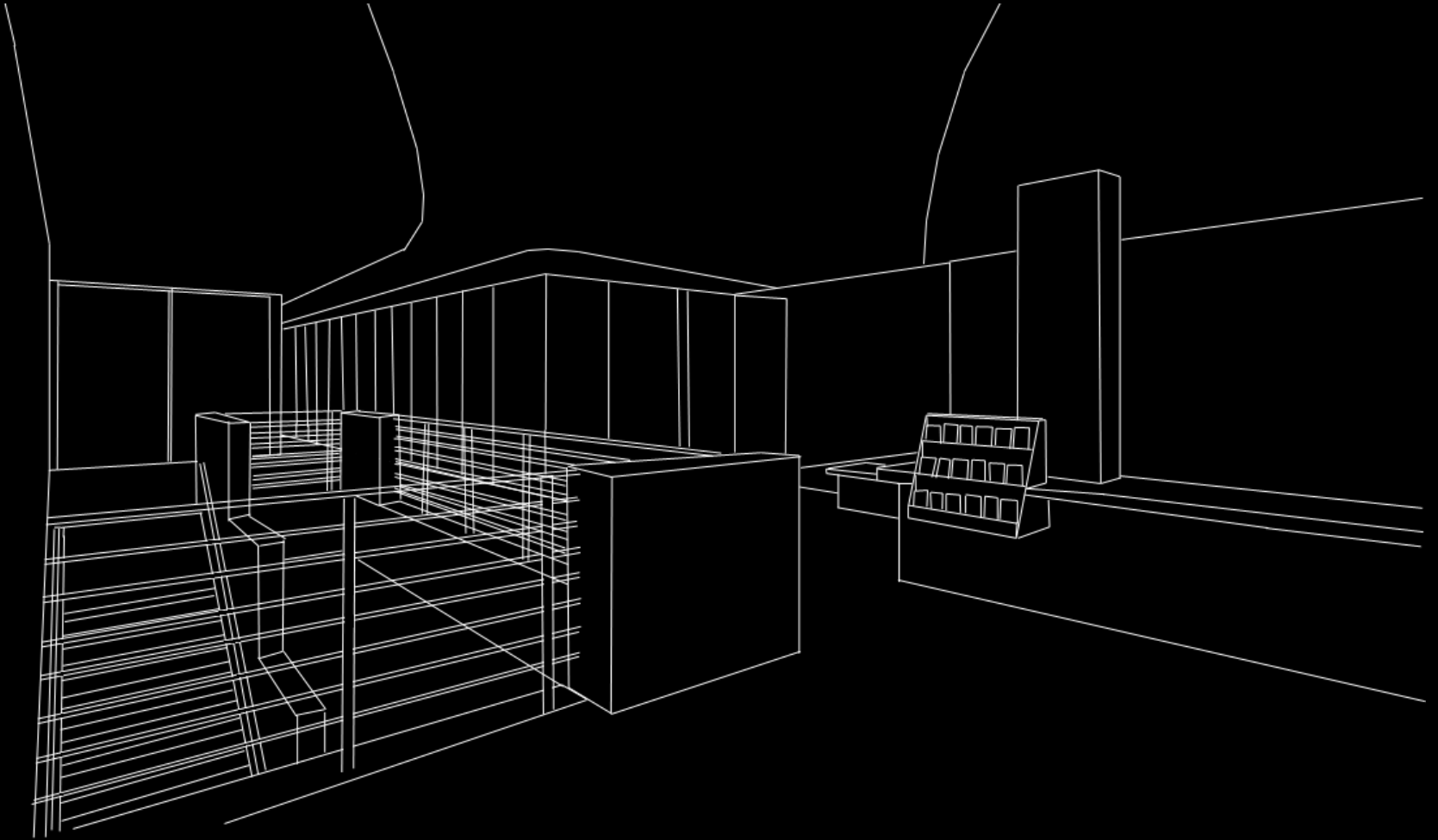

Main Lobby

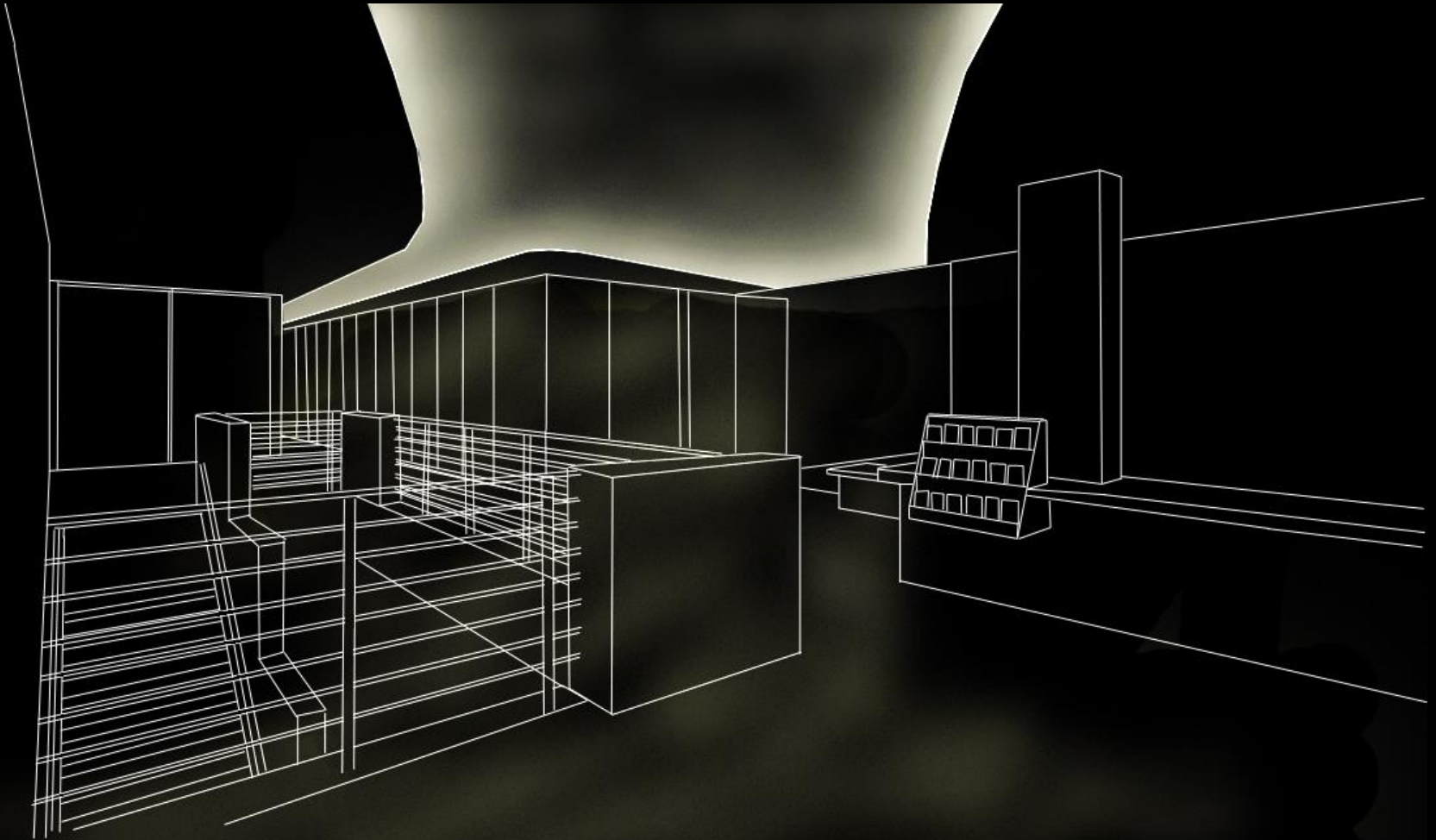

Main Lobby

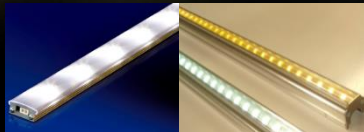
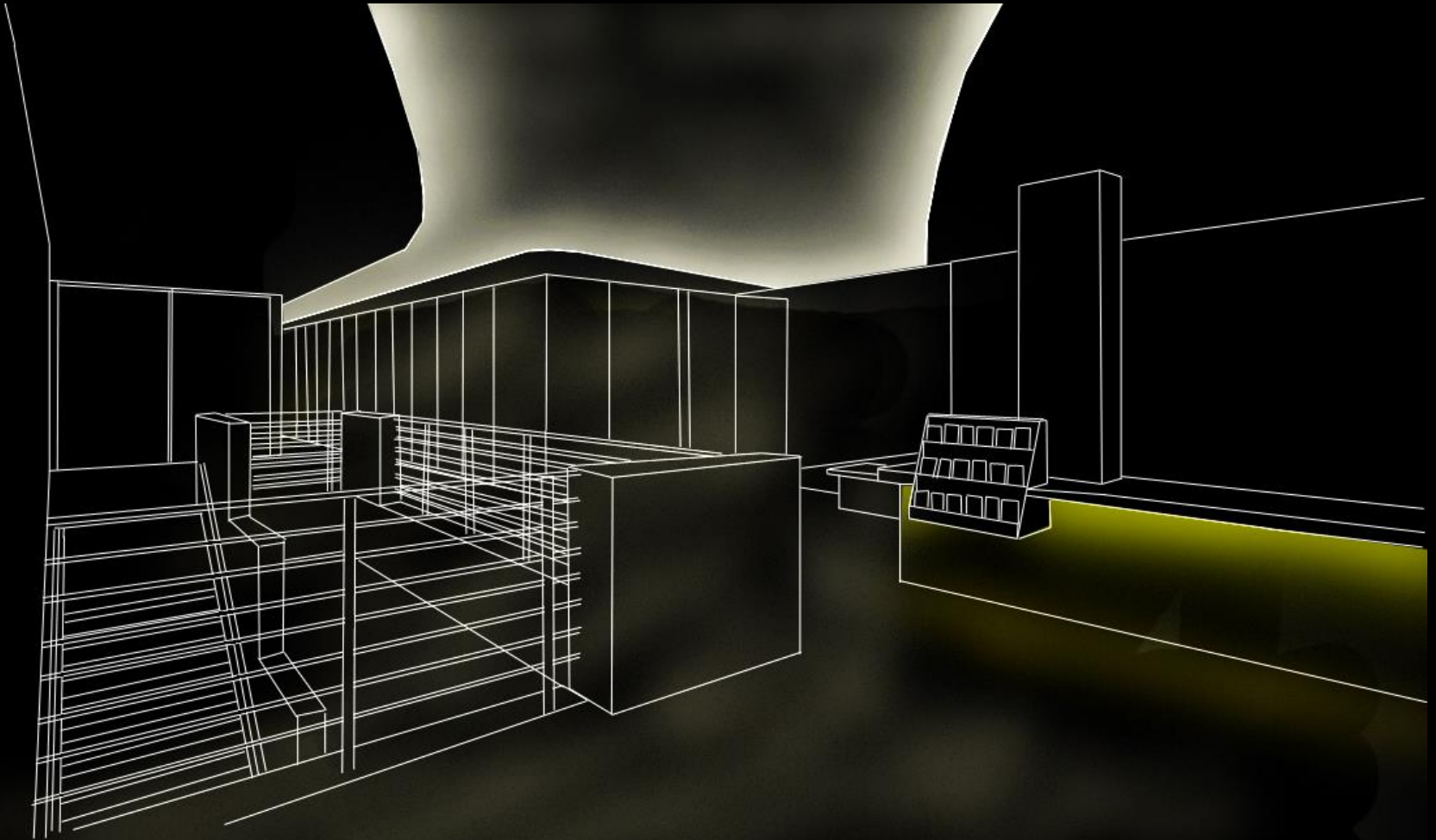

Main Lobby

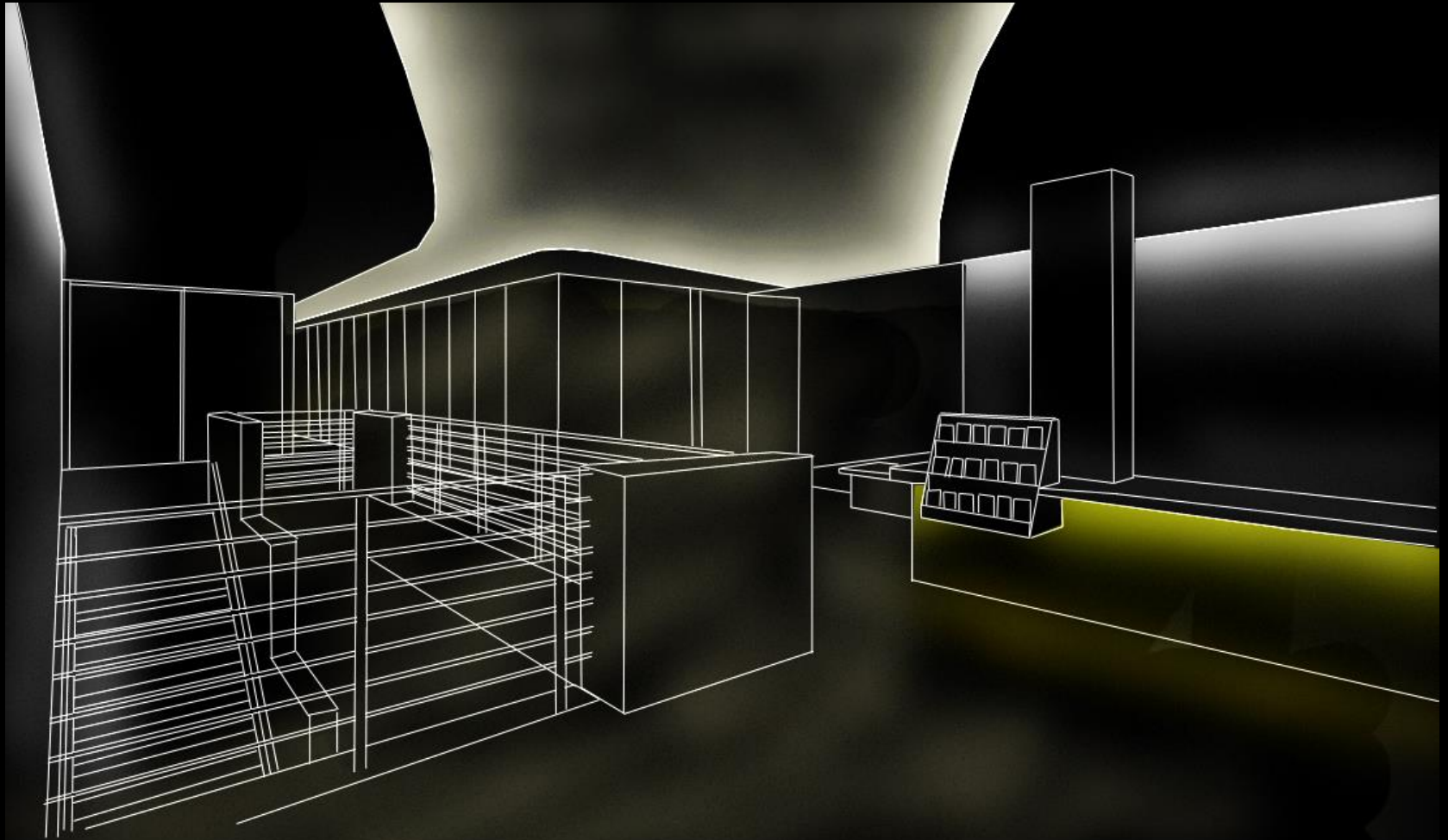

Main Lobby

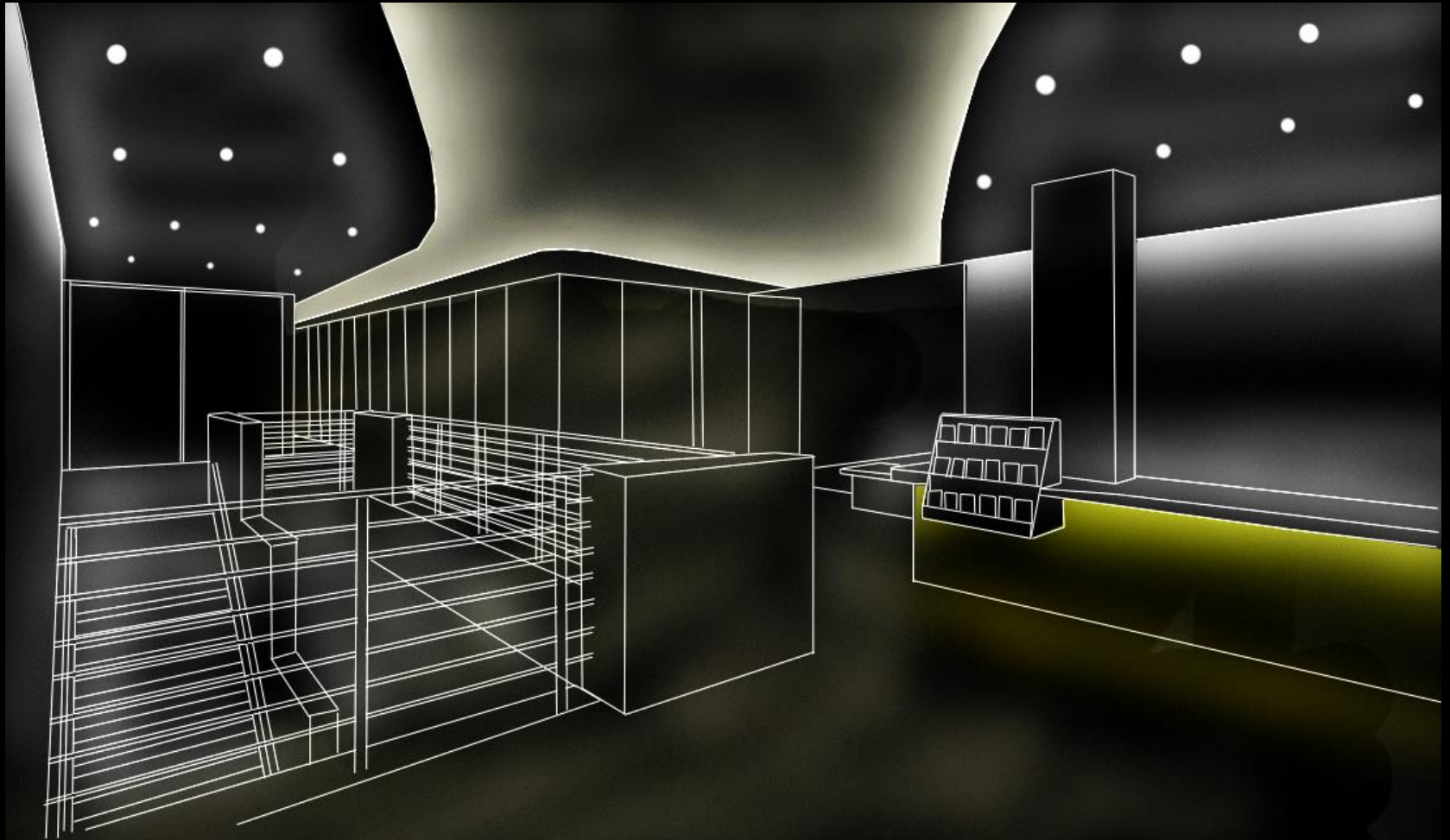

Main Lobby

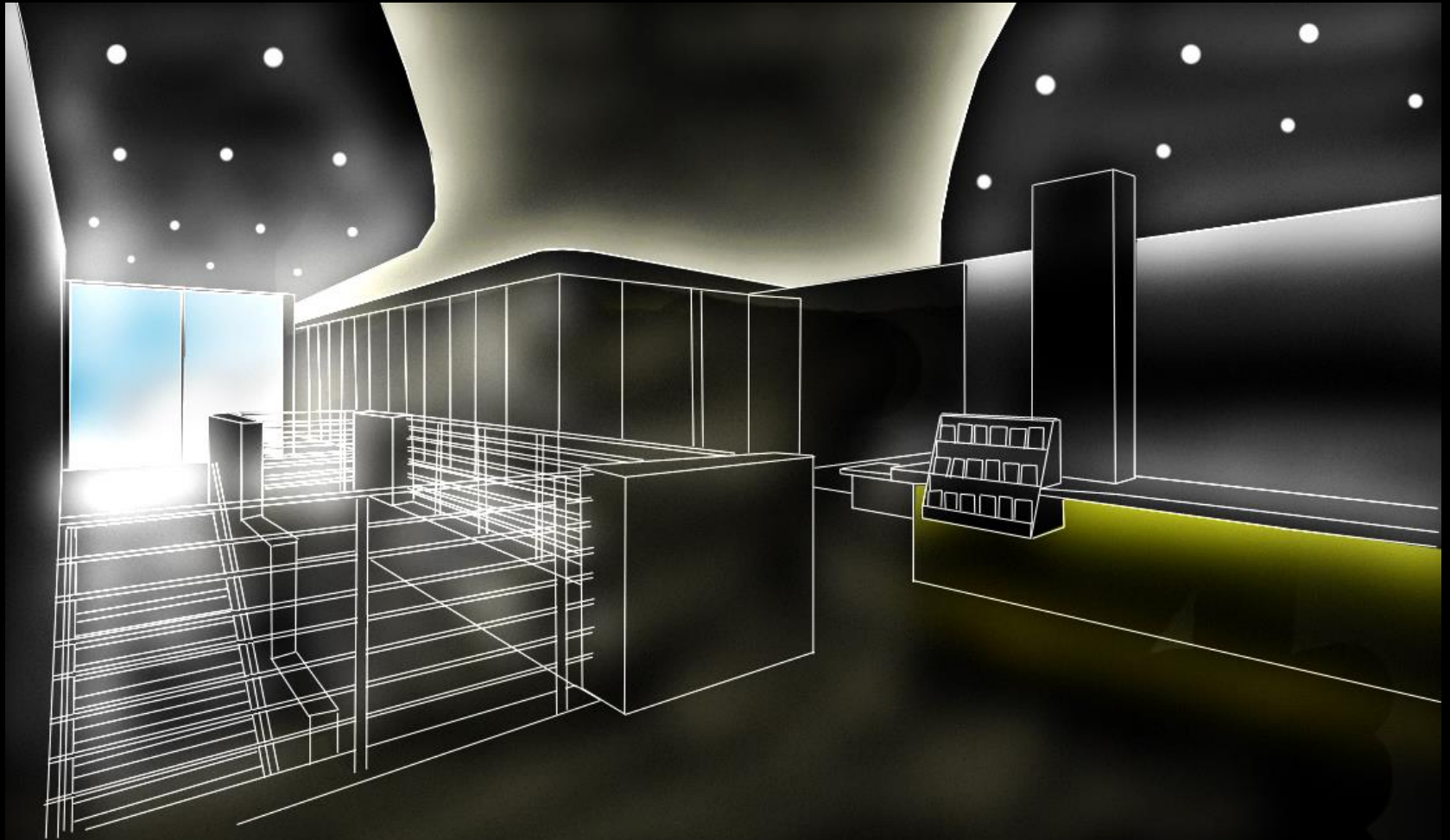

Performance Penthouse



Space purpose

- Performances
- Dance
- Classroom
- Banquet

Design goal

- Integrate daylight into the space
- Lighting control for various activities
- Provide Adequate illumination levels
- Uniform light distribution

Performance Penthouse

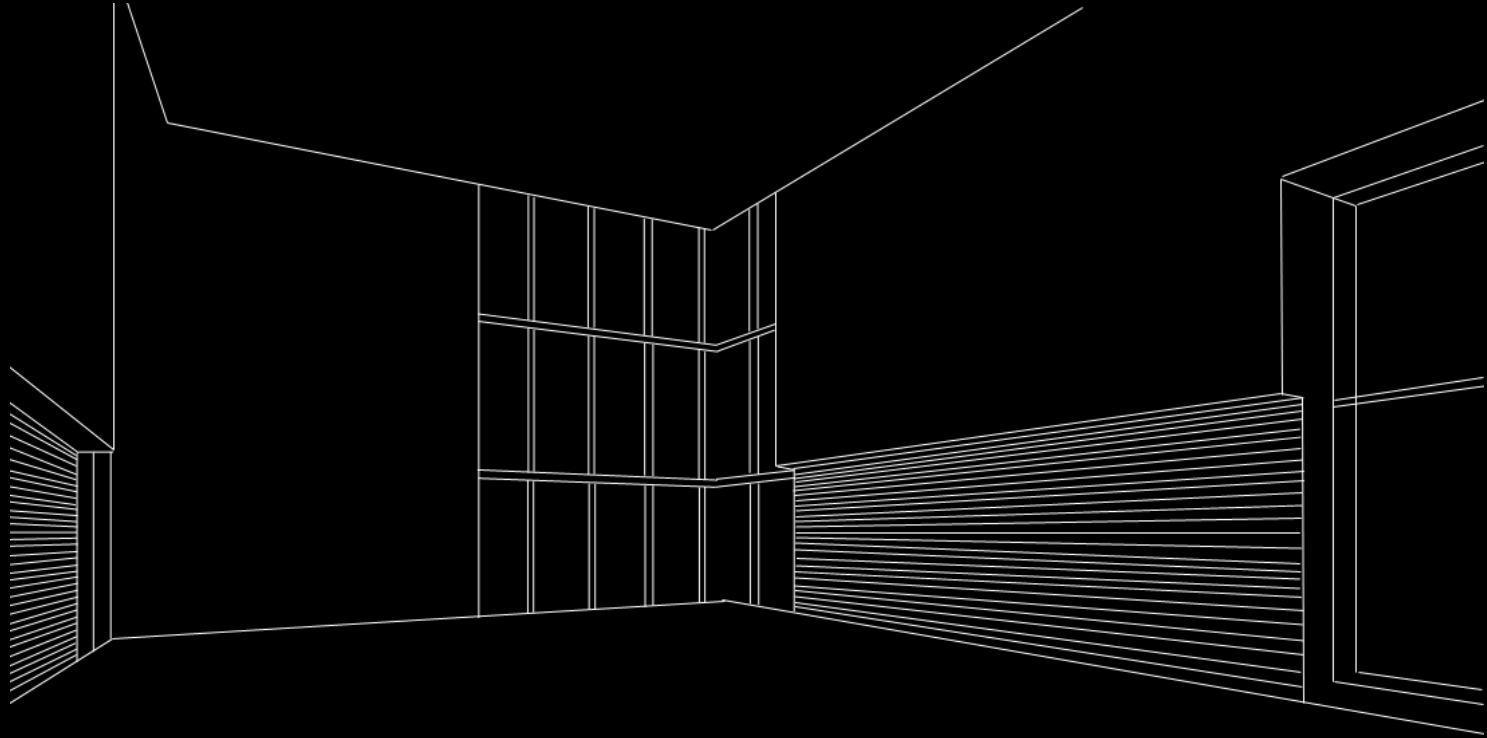

Performance Penthouse

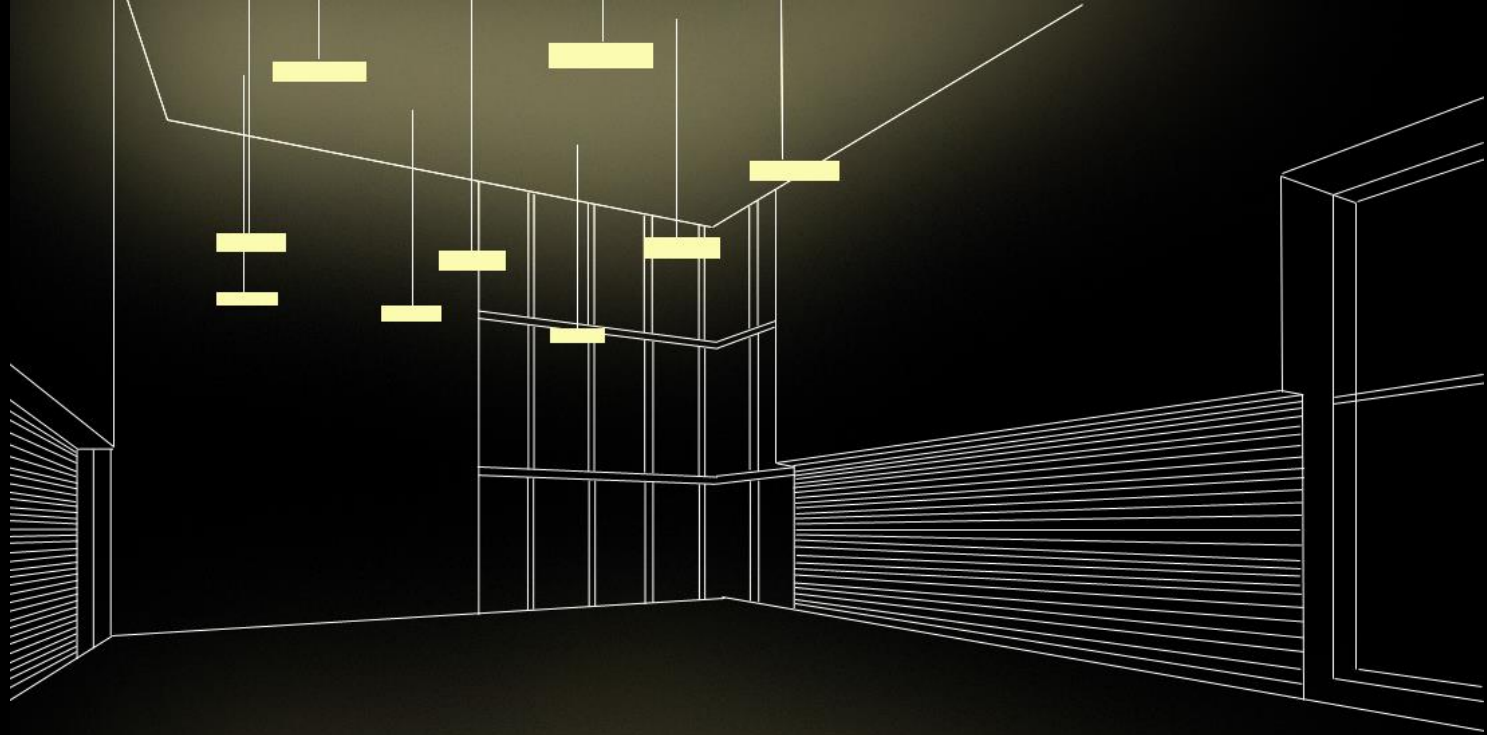

Performance Penthouse

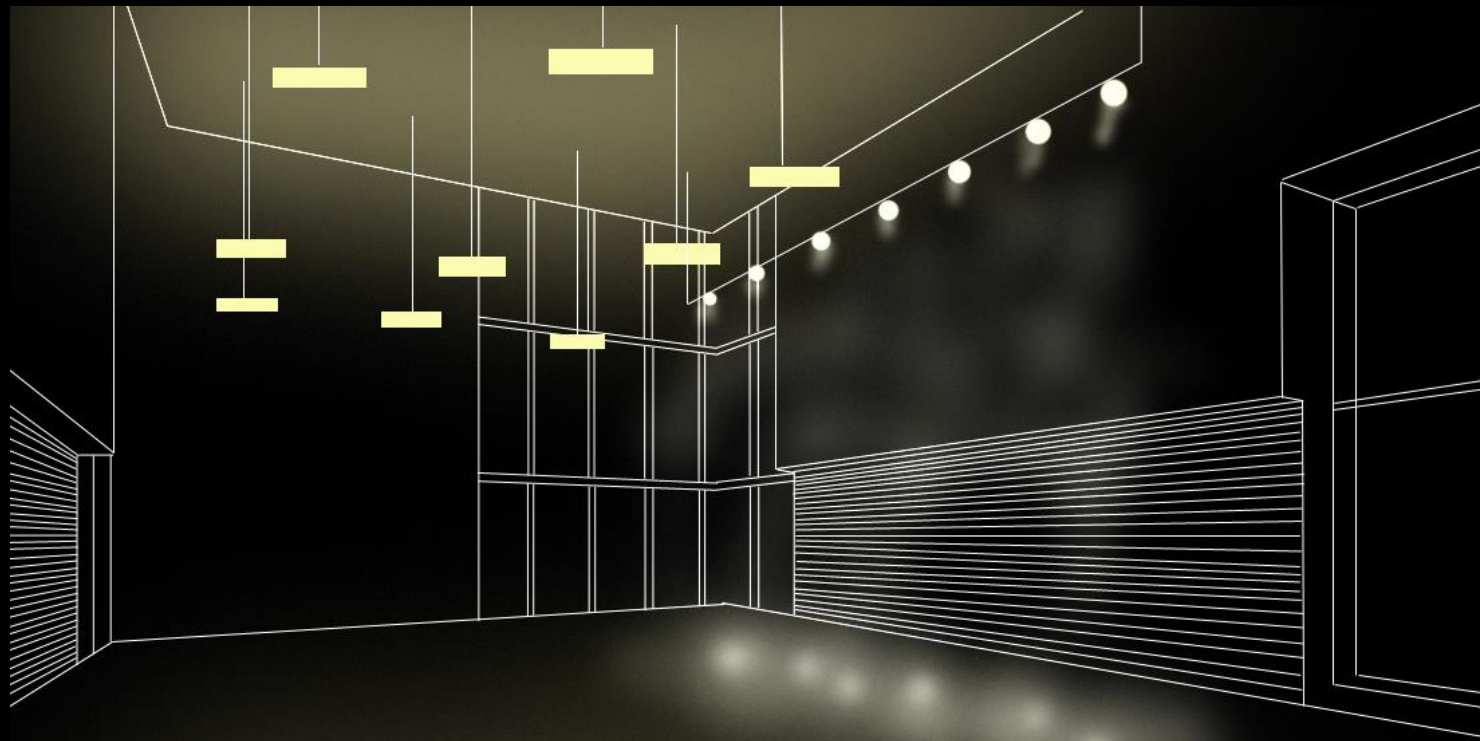

Performance Penthouse

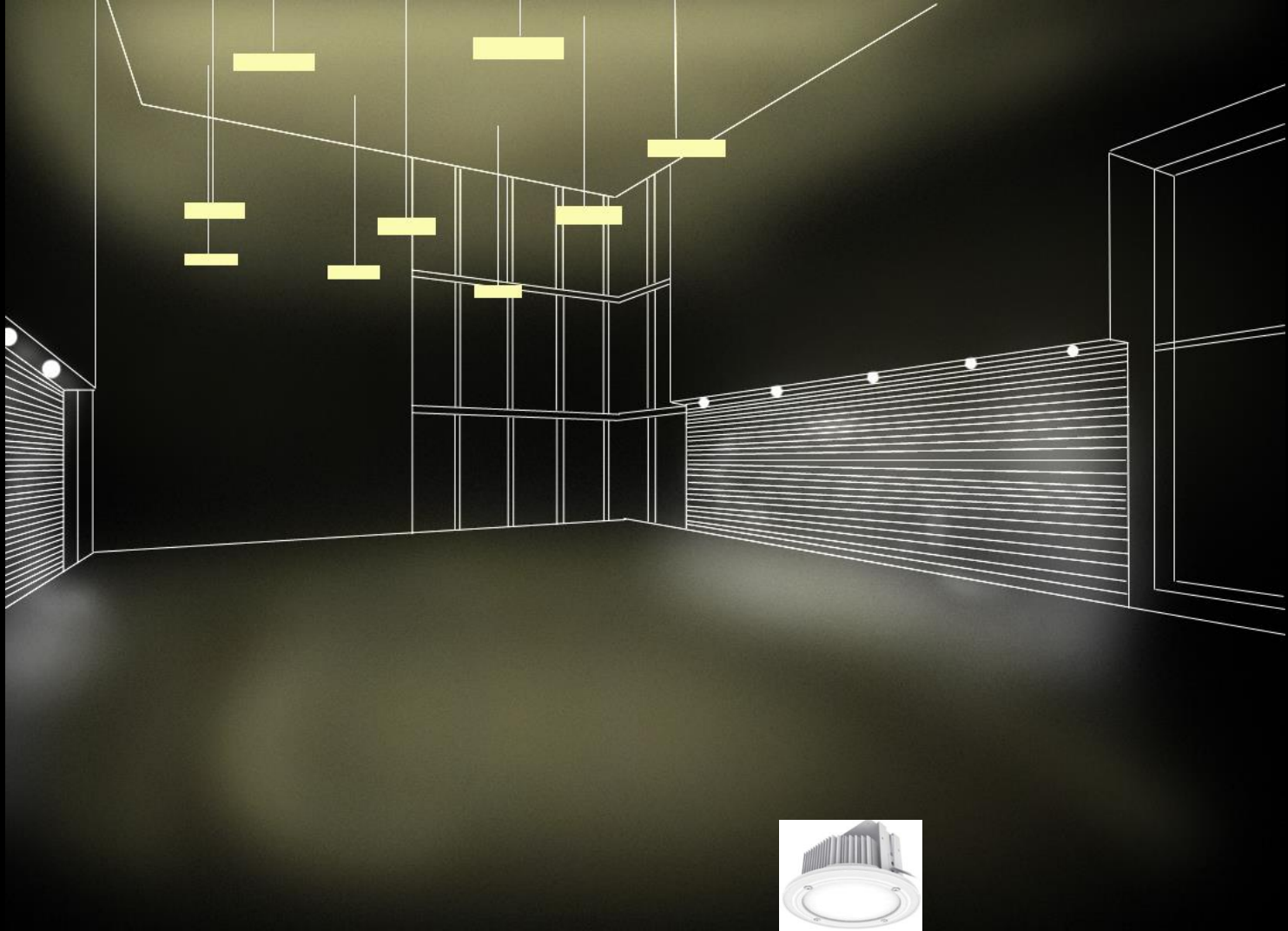

Performance Penthouse

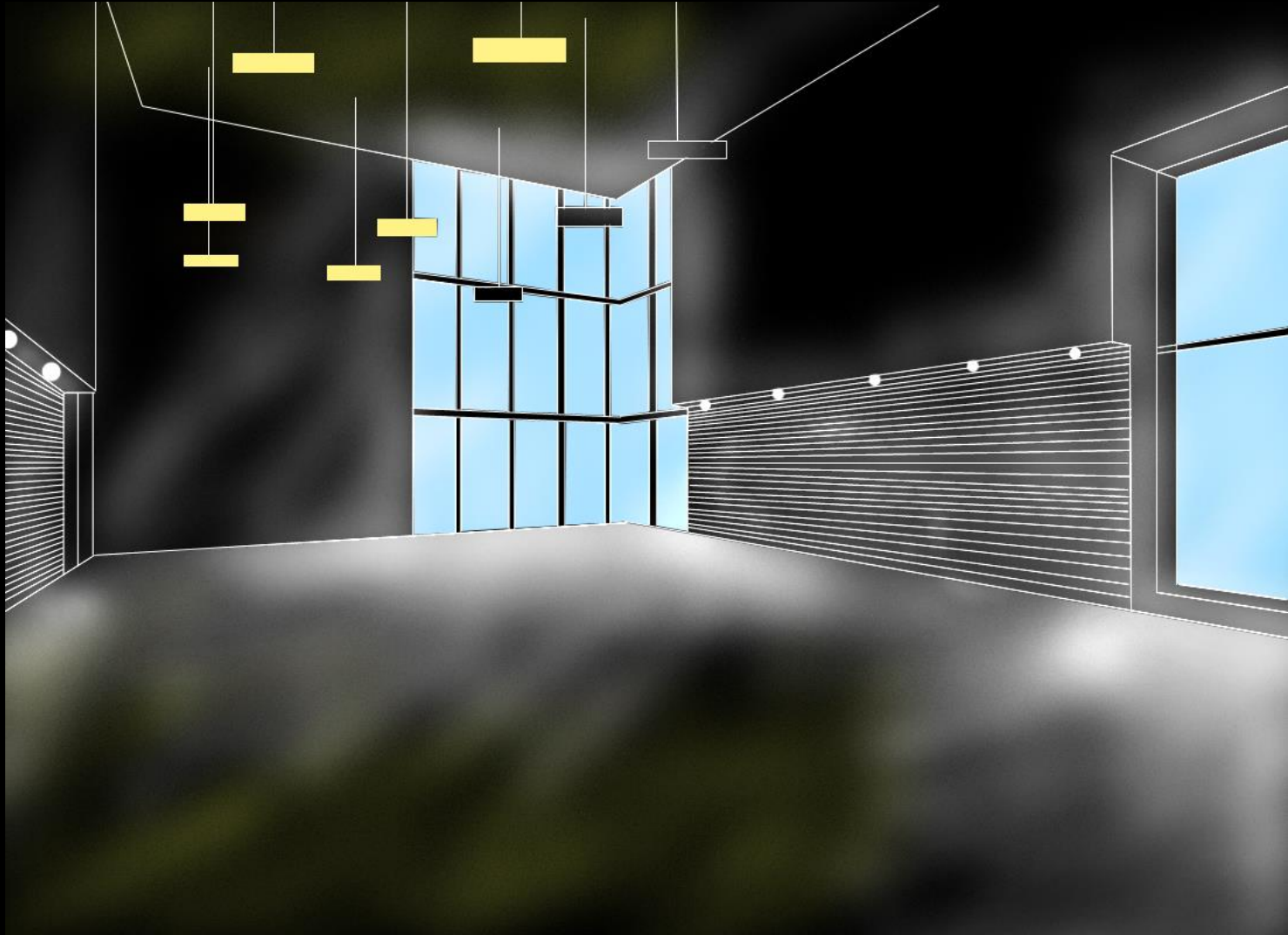



Space purpose

- Pathway
- Rest Area
- Outdoor performance

Design goal

- Provide light for way finding
- Adequate light for outdoor performance
- Avoid light trespass into the building
- Give relaxation feeling

Courtyard

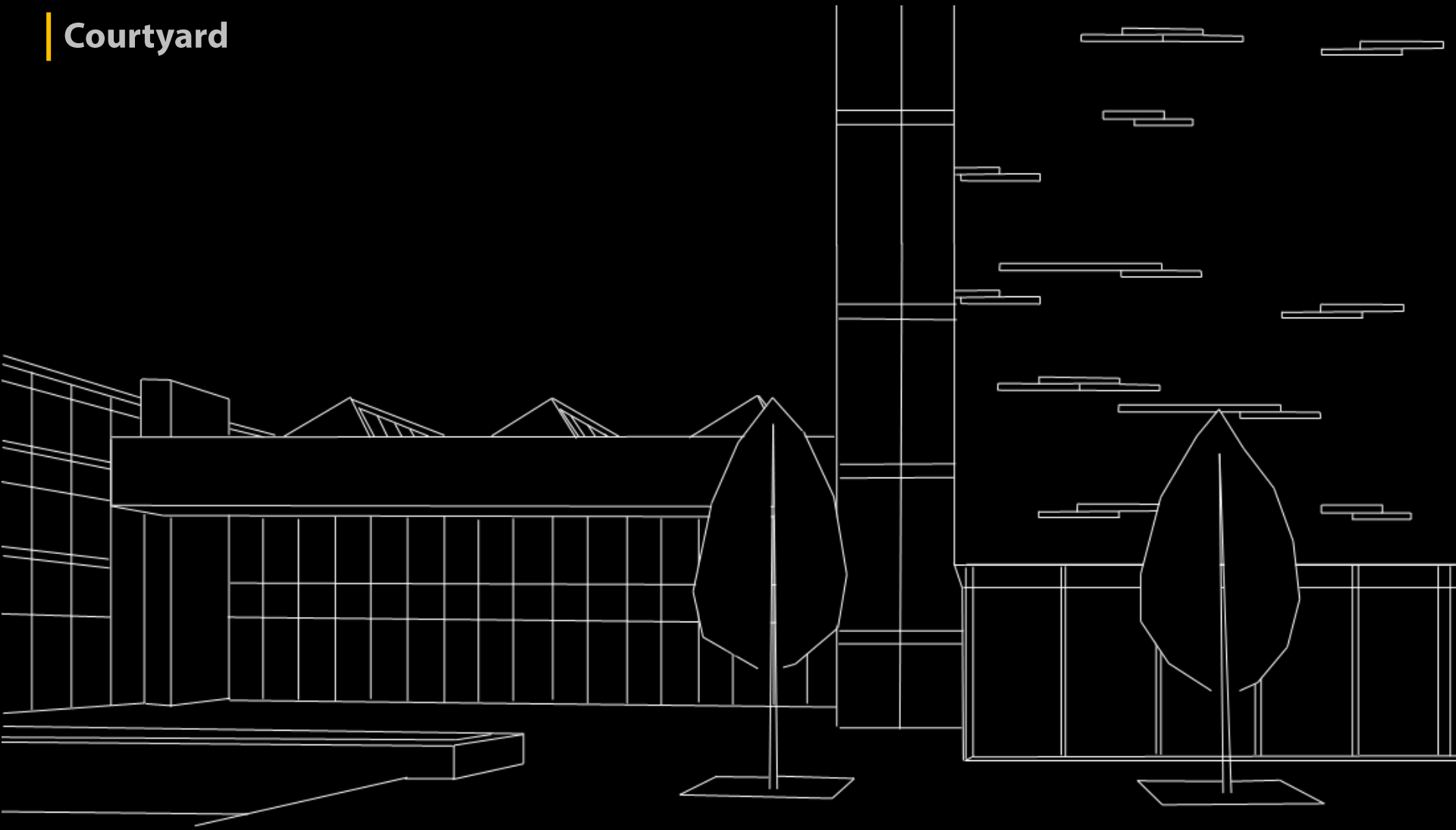

Courtyard

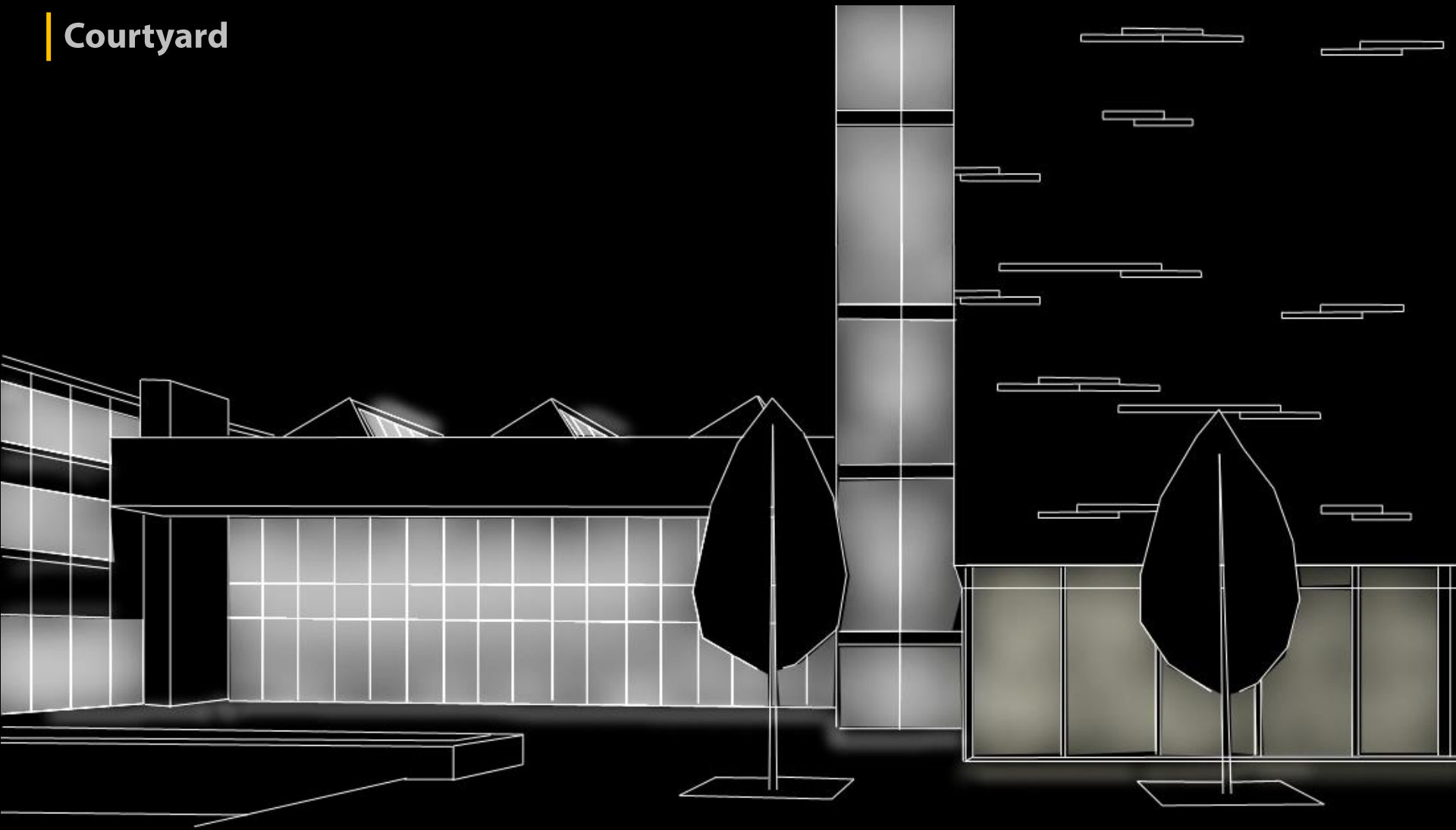

Courtyard

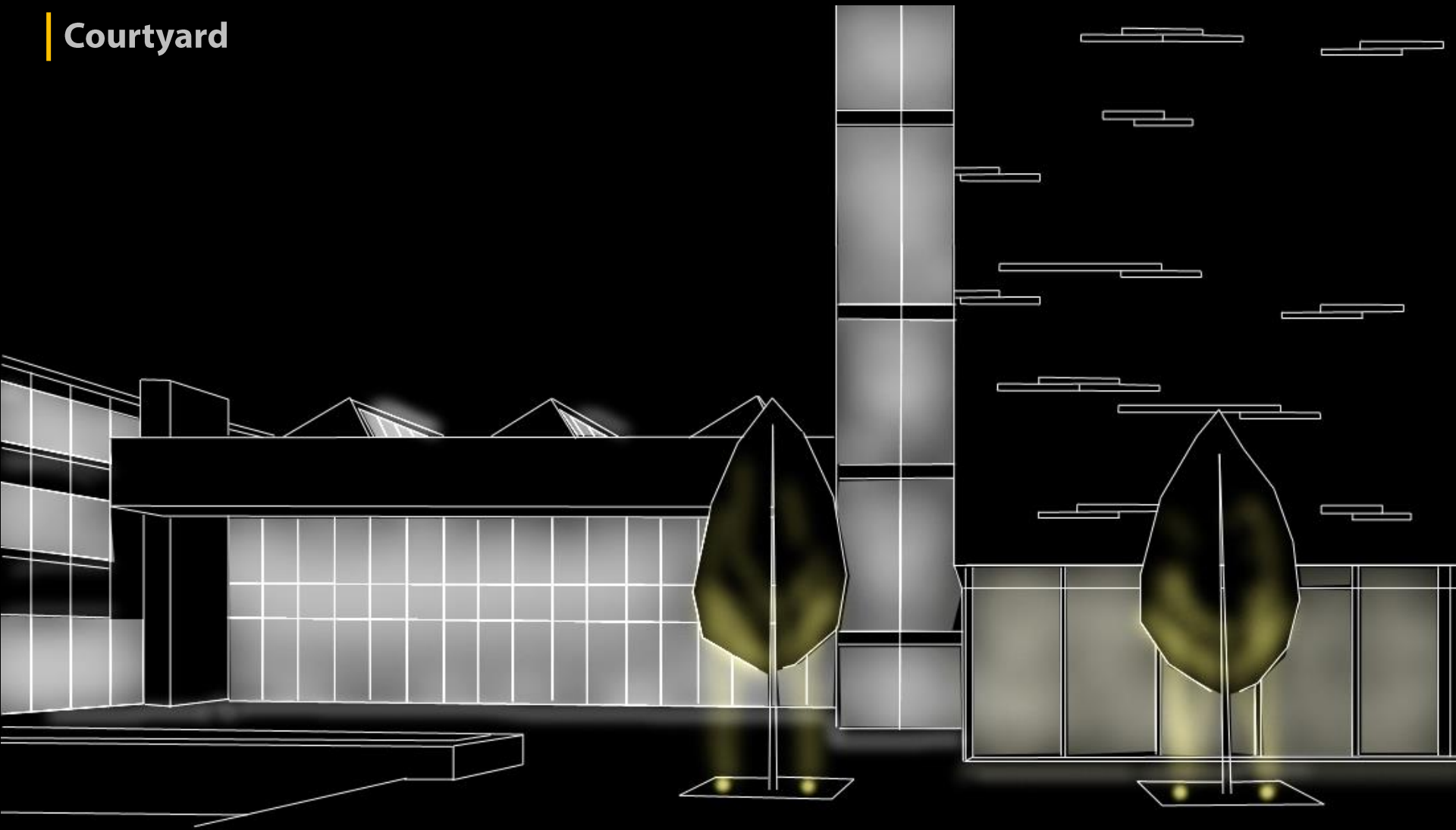

Courtyard

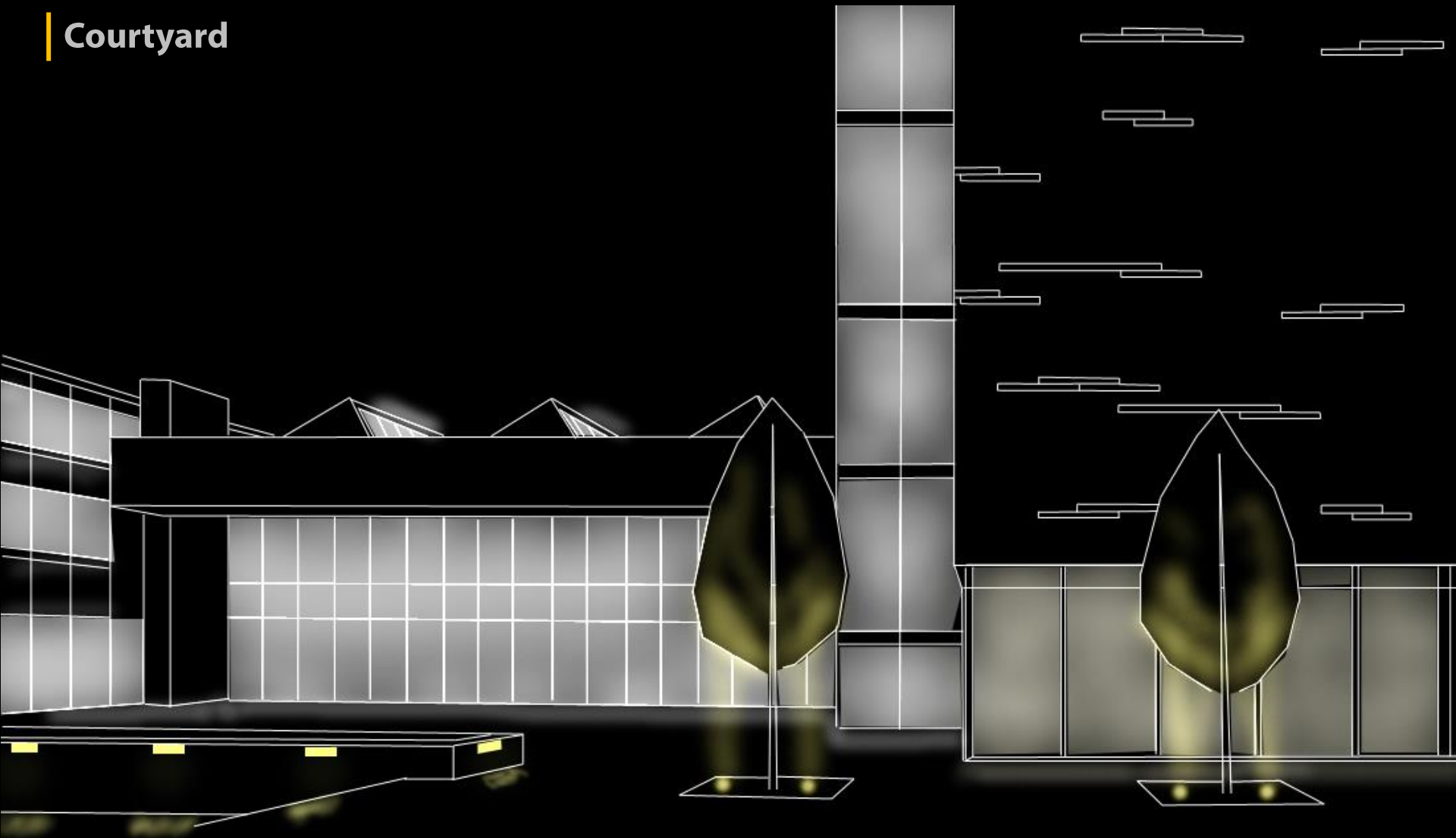

Courtyard

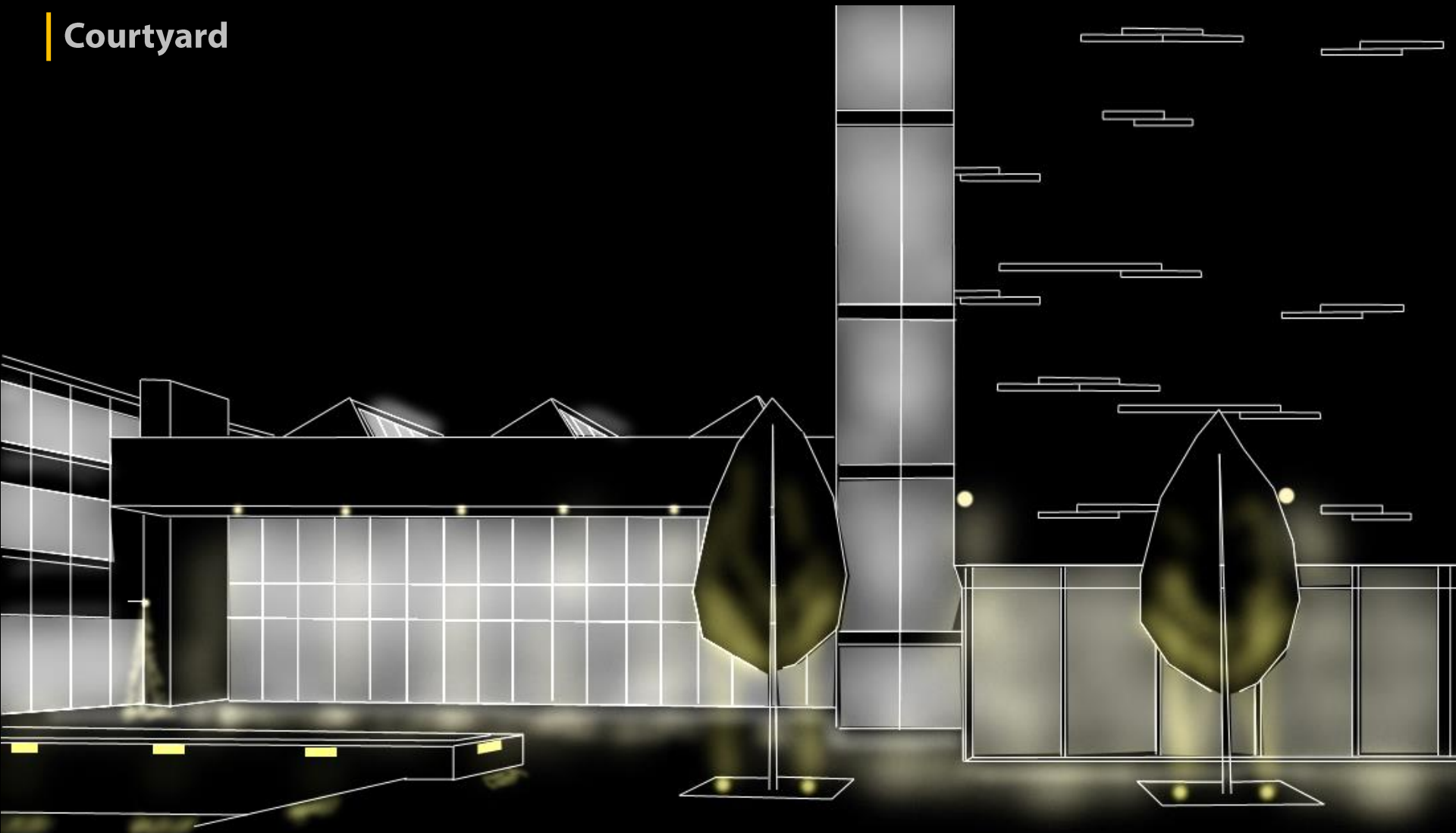

Courtyard

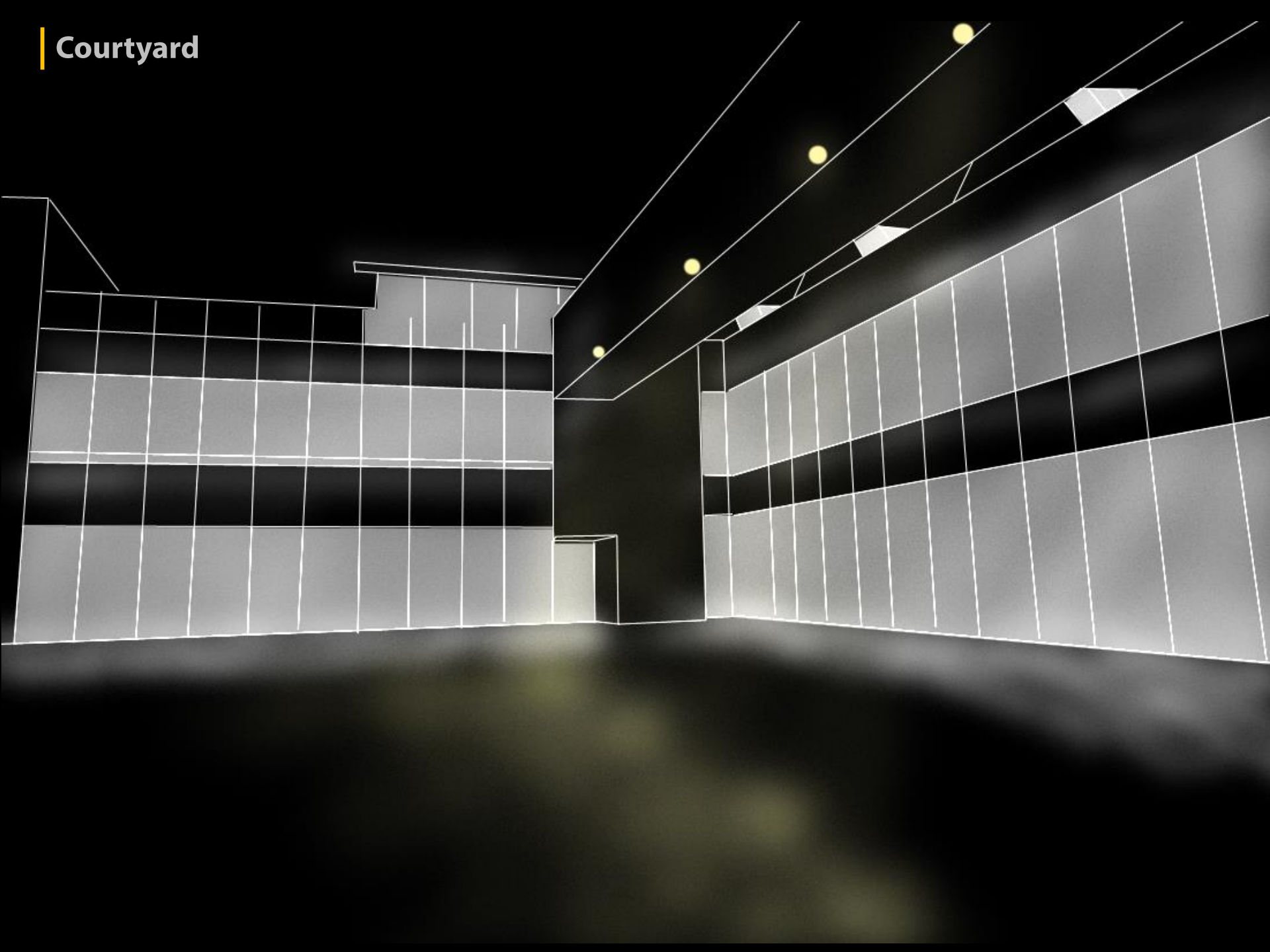

Performance Hall



Space purpose

- Performance
- Full orchestra
- Music, Dance, and Film

Design goal

- Flexible lighting for various activities
- Uniform light distribution with comfort
- Avoid visual distractions.
- Pleasant environment with relax atmosphere

Inspiration in Performance



Application

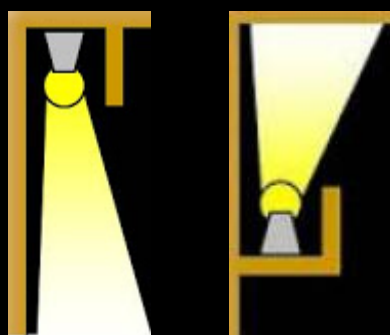

Performance Hall - Sophisticated

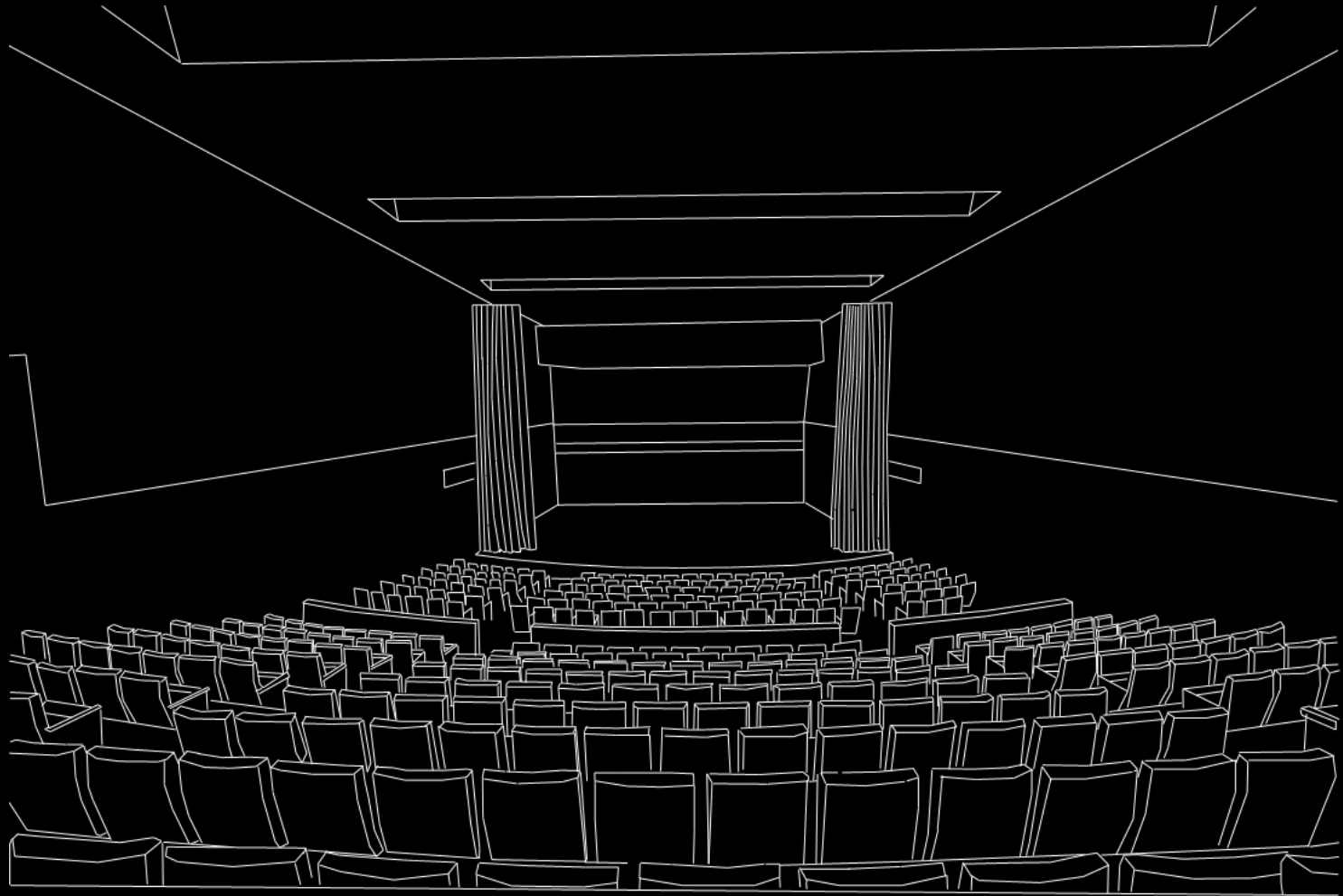

Performance Hall - Sophisticated

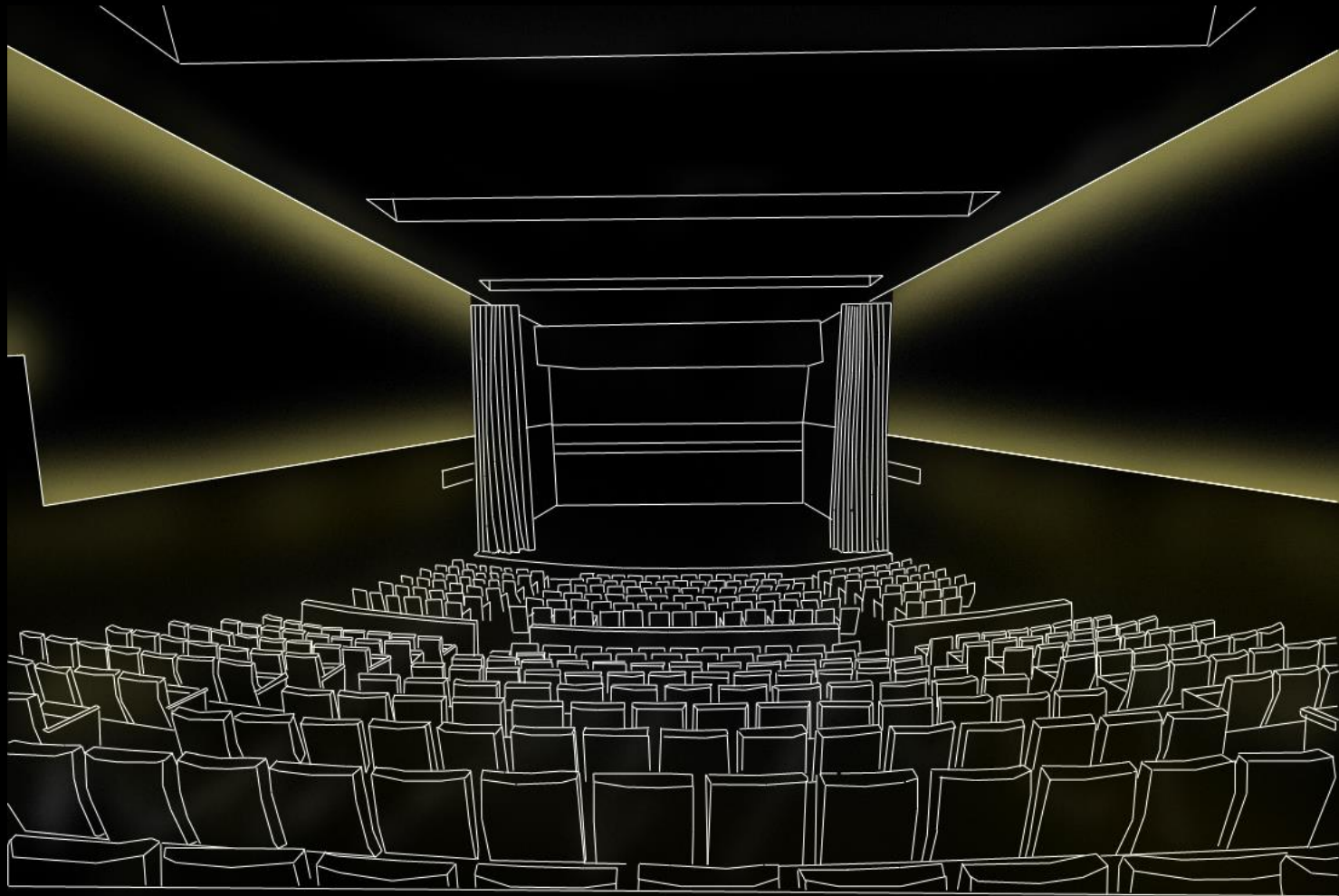

Performance Hall - Sophisticated

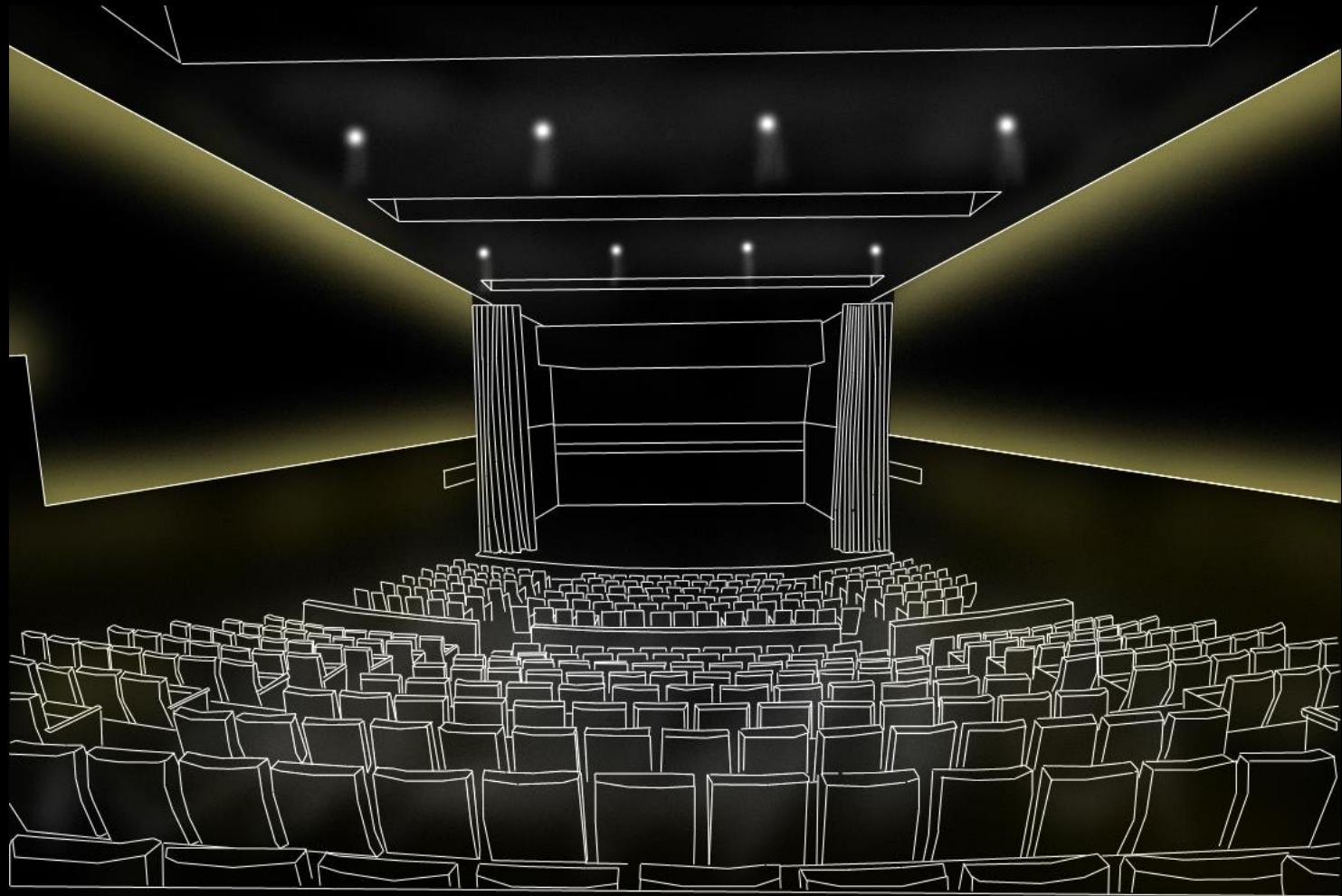

Performance Hall - Sophisticated



Performance Hall - Modernism

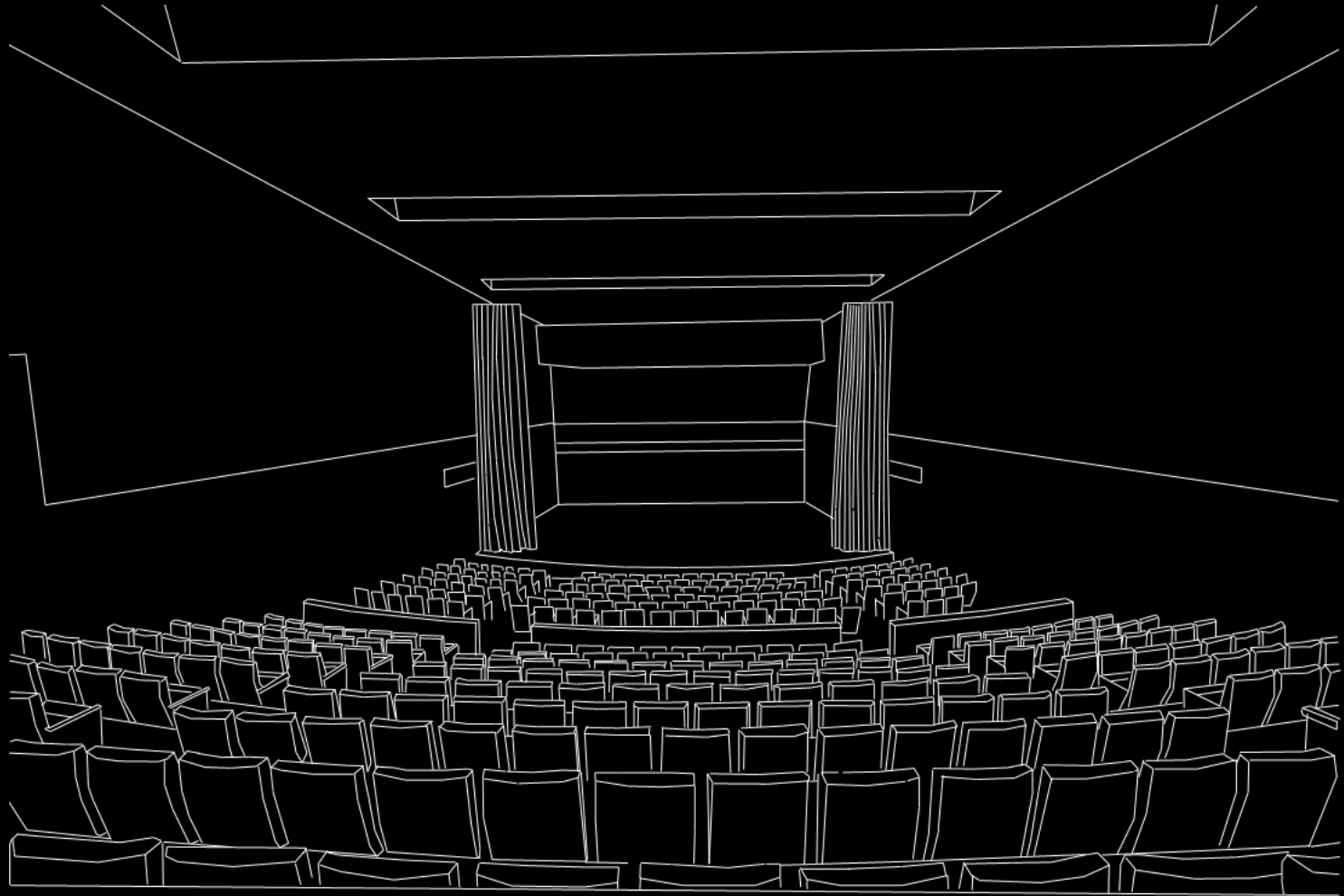

Performance Hall - Modernism

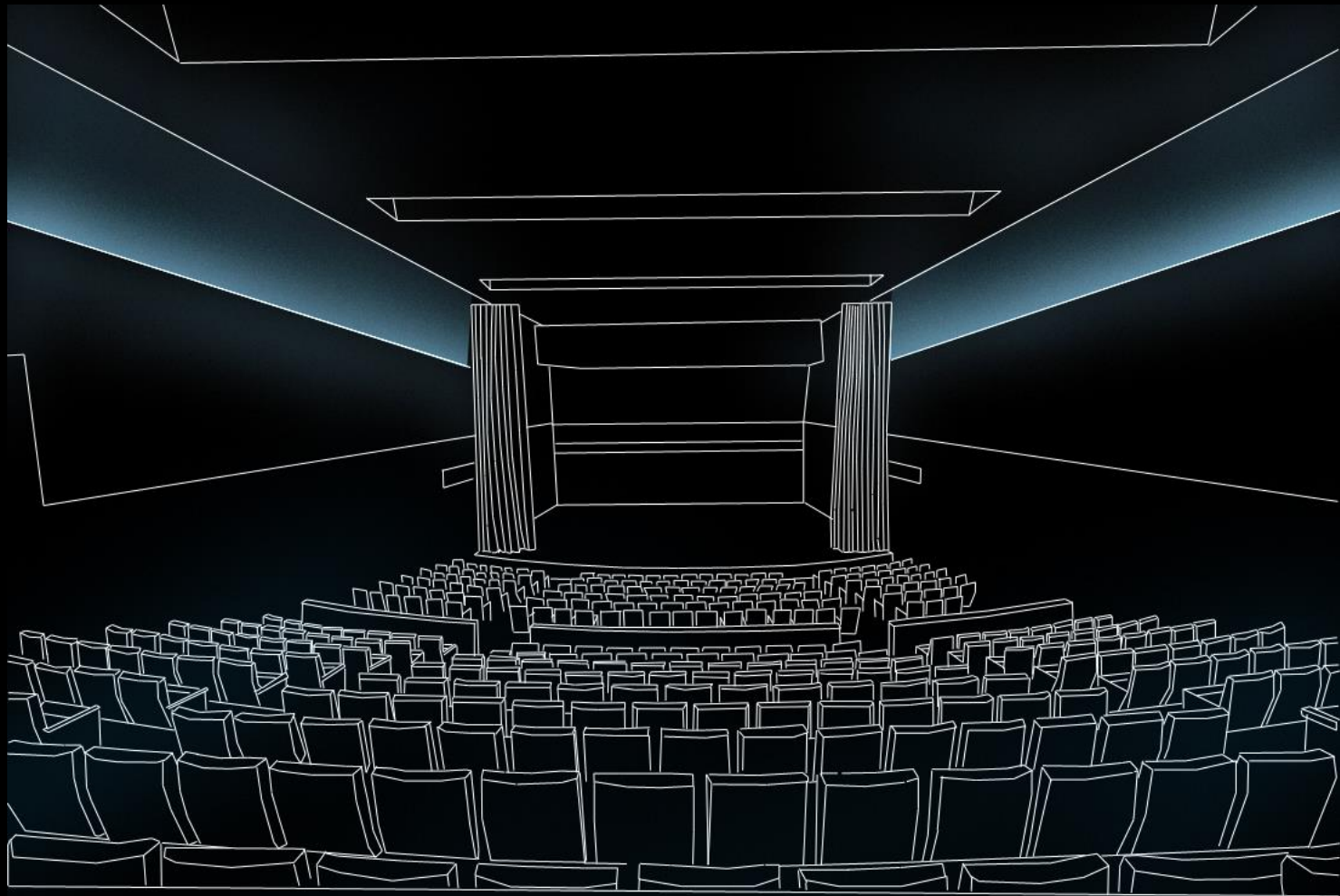
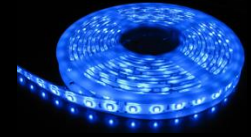

Performance Hall - Modernism

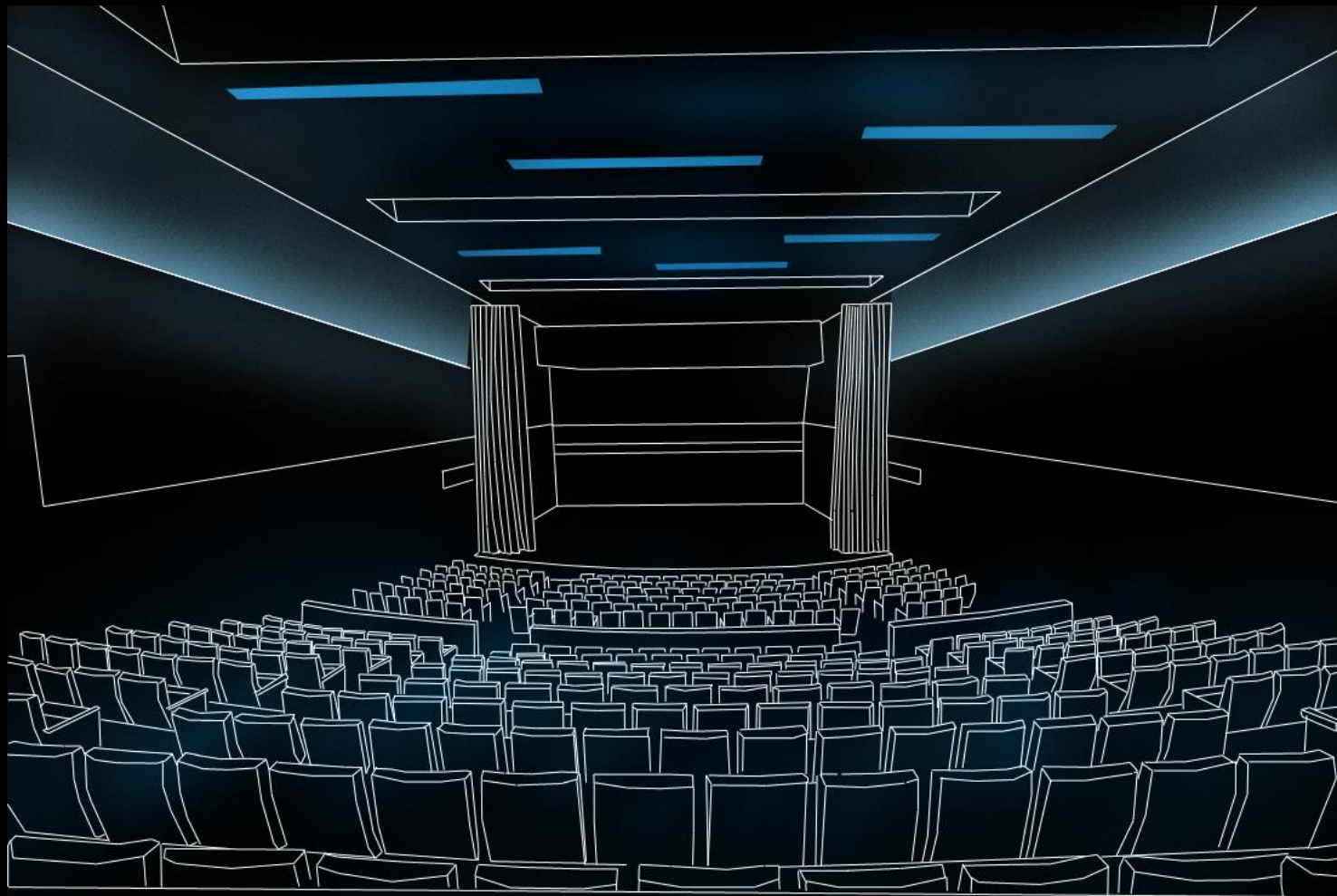

Performance Hall - Modernism

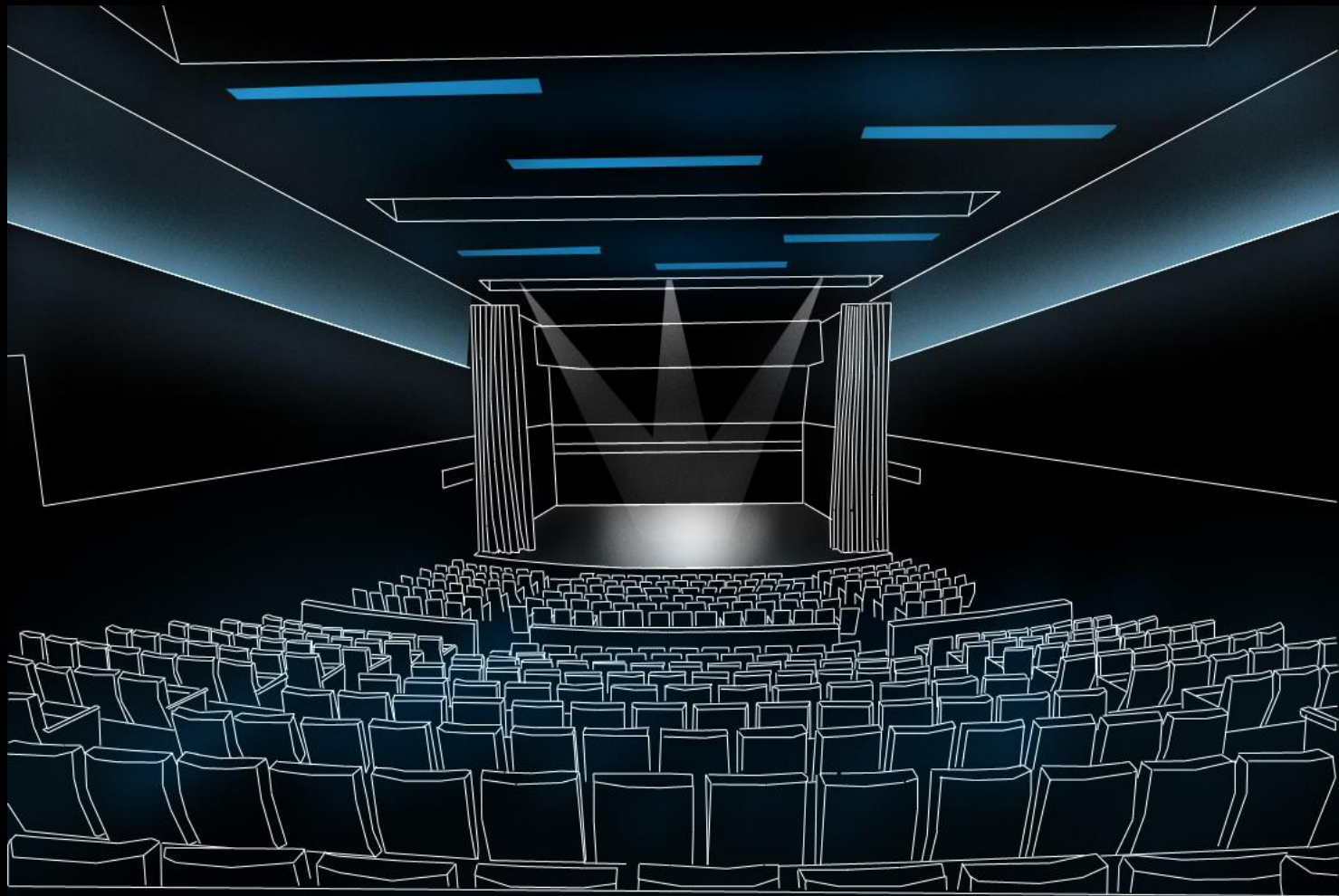

Performance Hall - Classical

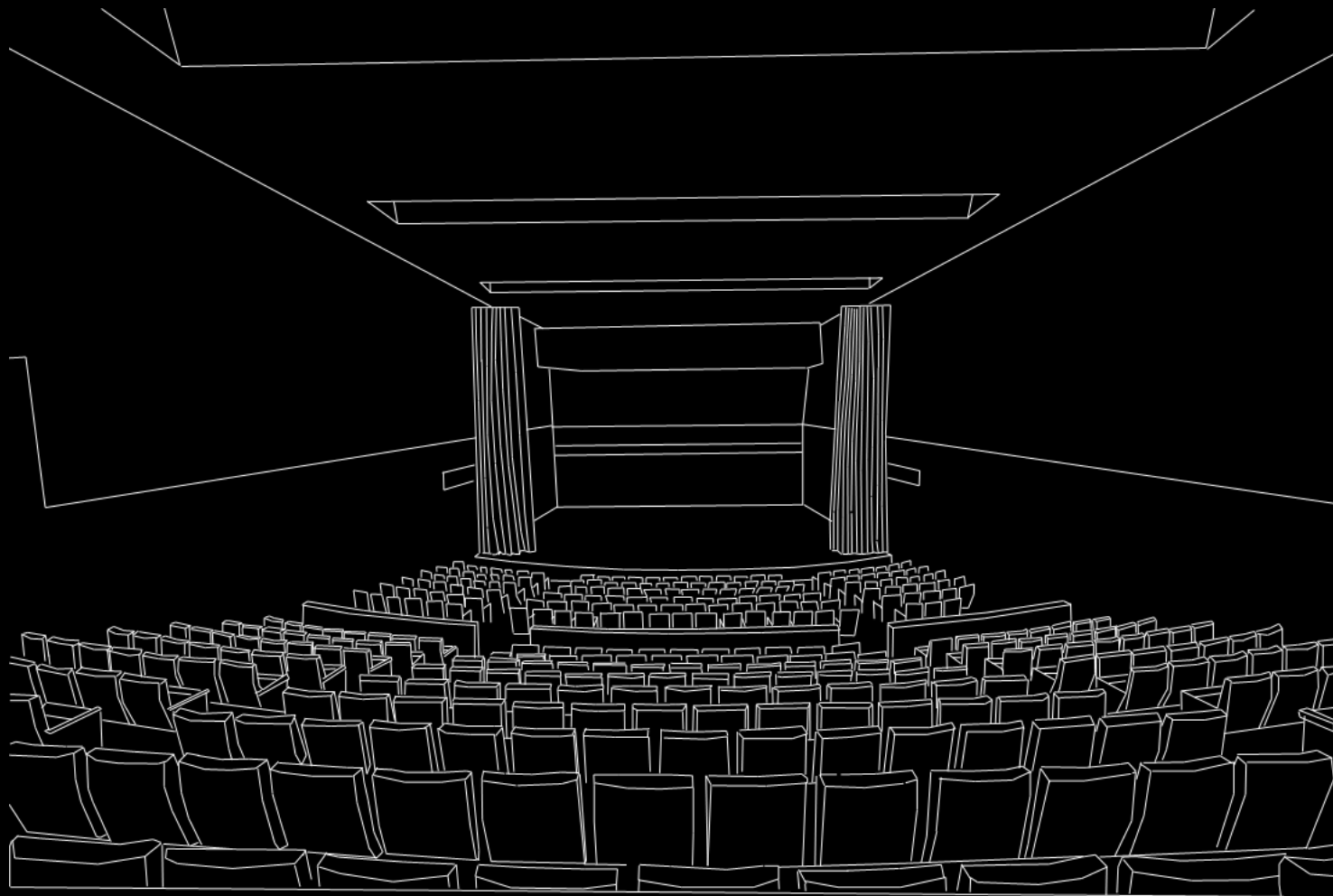

Performance Hall - Classical

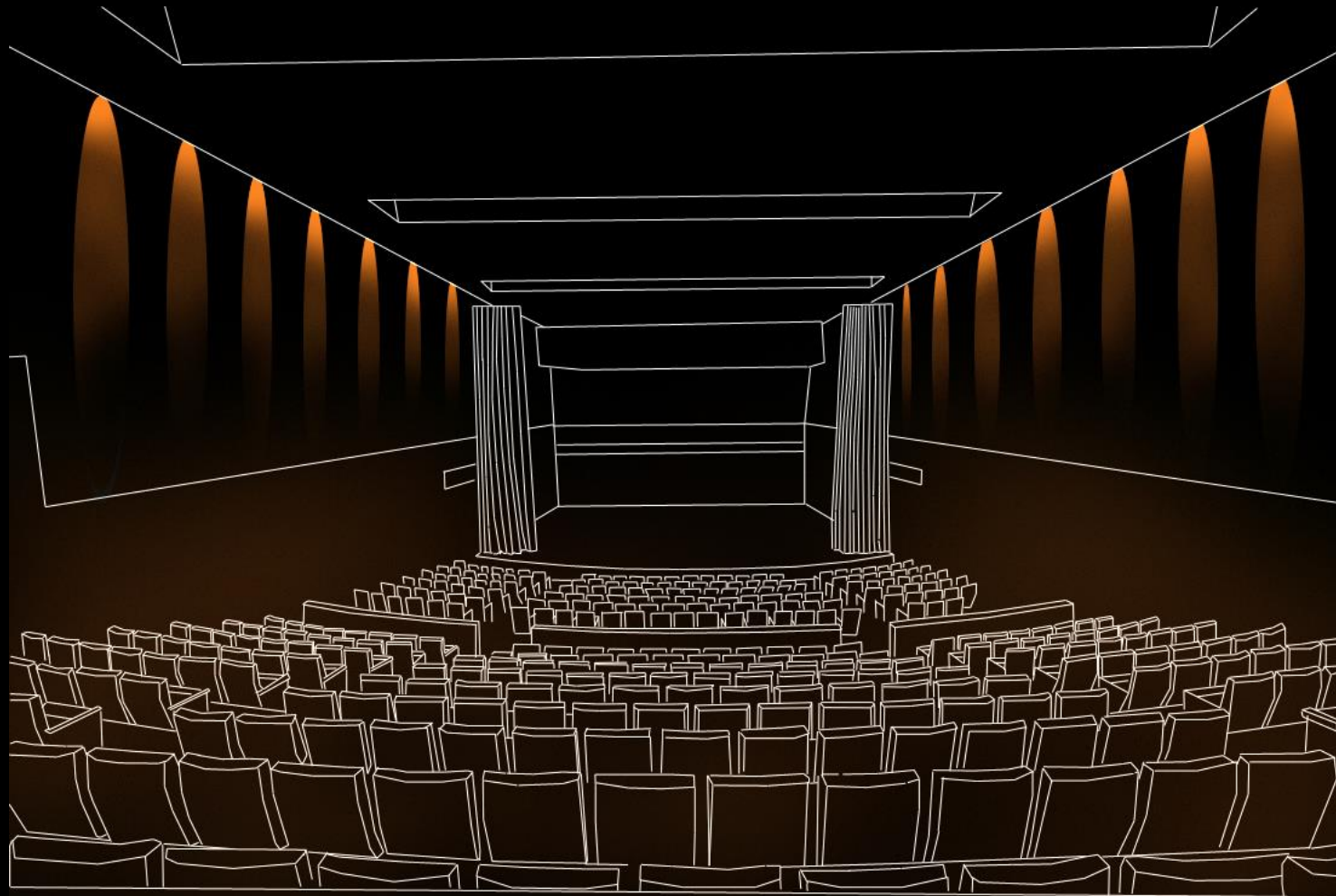

Performance Hall - Classical

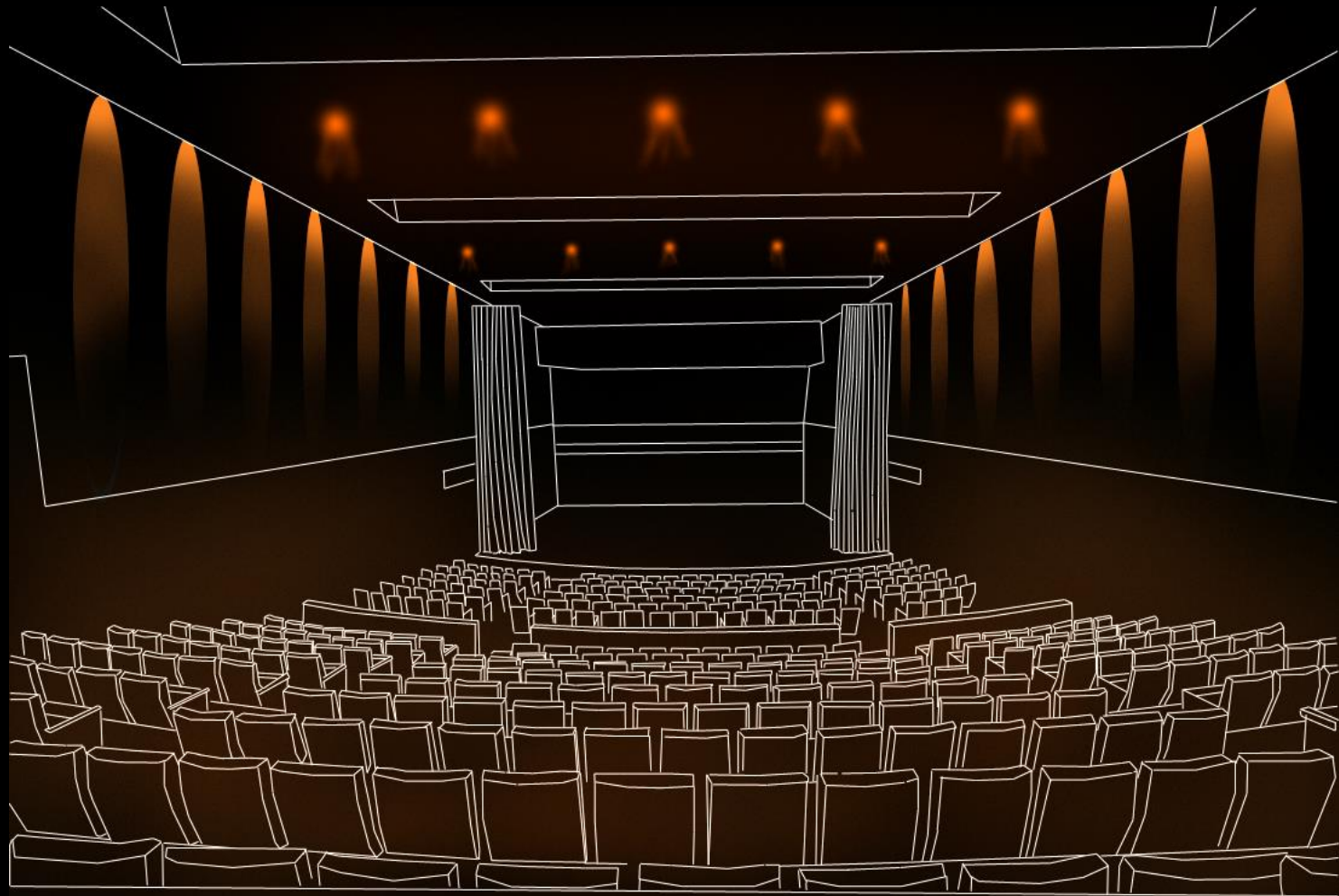

Performance Hall - Classical



Thank you! & Questions?

